

Monitor installation instructions

installation steps:

The first step: installation of the monitor bracket and the monitor

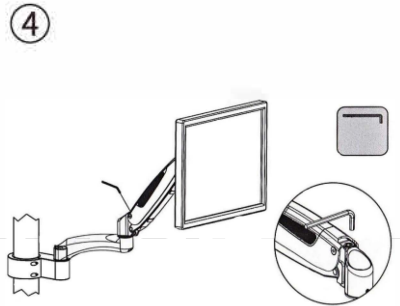
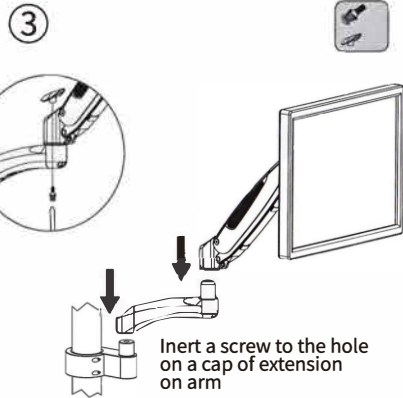
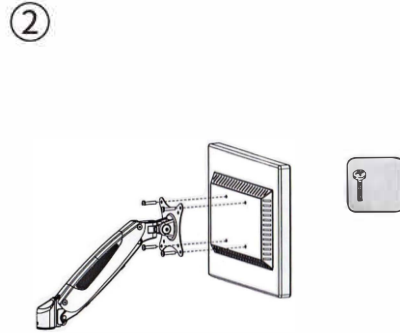
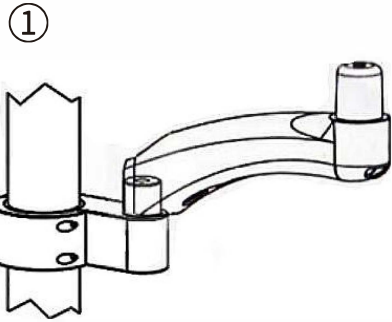

Inert a screw to the hole on a cap of extension on arm

Tips:The light screen can be adjusted in clockwise. The heavy monitor can be adjusted in anti-clockwise

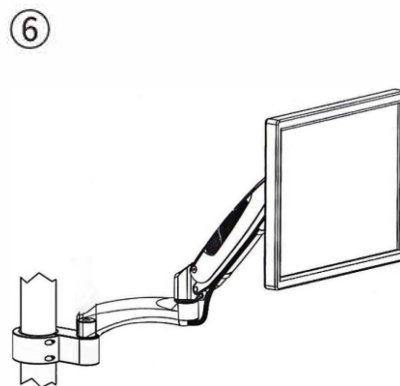
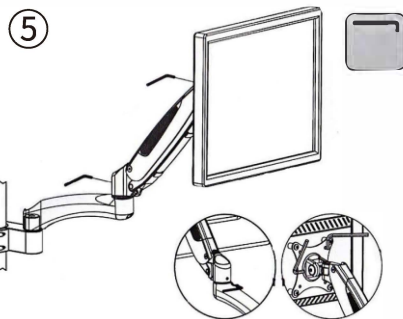

Tips:Rotate a wrench in clockwise to unscrew. Rotate a wrench in anti-clockwise to tighten screws

The second step:connect Power plug and HD plug

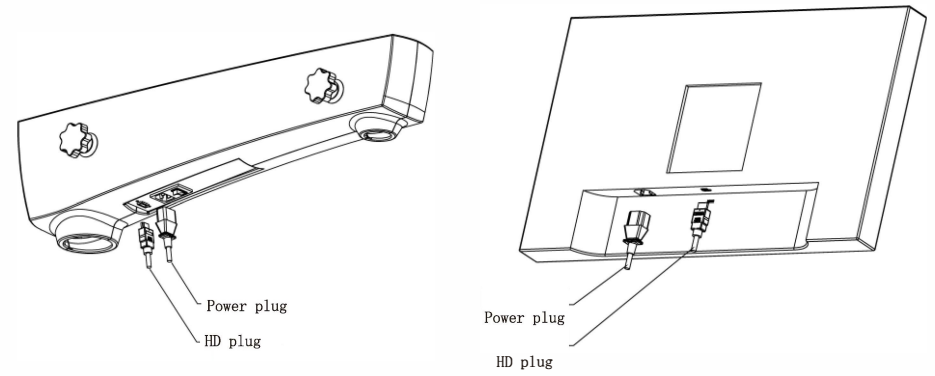

Note: Please refer to the corresponding instruction manual for the adjustment and use of the monitor.

